

## Fishers Pond

### Landscape Guidelines and Requirements

Recommended minimum landscape budget is \$4,000. While the budget is a good guideline, each landscape requires individual assessment and execution. Care in the selection of a landscape professional to oversee the installation is recommended.

Depending on the size of the lot, there should be at least five substantial trees on the property, including existing trees. Special consideration will be given to those whose plans incorporate existing hardwoods and native specimens. Substantial trees shall include 2" caliper hardwoods, older growth pines (12" caliper), and 1.5" caliper (or 8'-10') flowering species such as dogwoods and serviceberry.

In addition, each yard shall contain appropriate foundation plant material and sod. Irrigation systems are strongly recommended. An average size lot should contain at least:

- \* 4 plants in a 15-gallon container (4' – 5' average)
- \* 8 plants in a 7 or 10-gallon container (3' – 4' average)
- \* 20 plants in a 3 or 5-gallon container (24" – 36" average)

Please note that screen planting is required at garage turn-around, if applicable. Also, all utility boxes and heating units shall be screened from view. Appropriate screen material includes wax myrtles, tea olives, ligustrum, native evergreen hollies, evergreen cypress varieties, and other such species.

In order to maintain a cohesive look throughout the neighborhood, each landscape should attempt to match the general theme of the neighborhood. This will include utilizing the following species, with attention to native species.

#### **Recommended Plants:**

Holly (D. Yaupon, Upright Yaupon, Compacta, Burfordi, Mary Nell, Nellie Stevens, etc.)  
Inkberry Holly  
Virginia Sweetspire  
Clethra  
Tea Olive (Fragrant and Holly-Leaf)  
Loropetalum  
Dwarf Pittosporum  
Viburnum (Tinus, Japanese)  
Wax Myrtle  
Azalea (indica, native, and others)  
Camellia  
Abelia  
Forsythia

#### **Recommended Trees:**

Red Maple, Elm, Magnolia, Red Oak, Live Oak, Willow Oak, River Birch, Redbud, Cherry, Sweetbay, Tulip Poplar, Serviceberry, Dogwood, Gordonia



25' NATURAL BUFFER @ REAR  
(HAND CLEAR ONLY)

IRRIGATION SYSTEM  
OF ADEQUATE DESIGN FOR PLAN

NO. REQ'D.	PLANT LEGEND
1	(A) 25 GAL TREE (E.G. MAPLE, OAK, MAGNOLIA)
2	(B) 15 GAL KEY PLANTING (E.G. HOLLY)
4	(C) 7 GAL BREAK PLANTING
25	(D) 3 GAL INFILL PLANTING

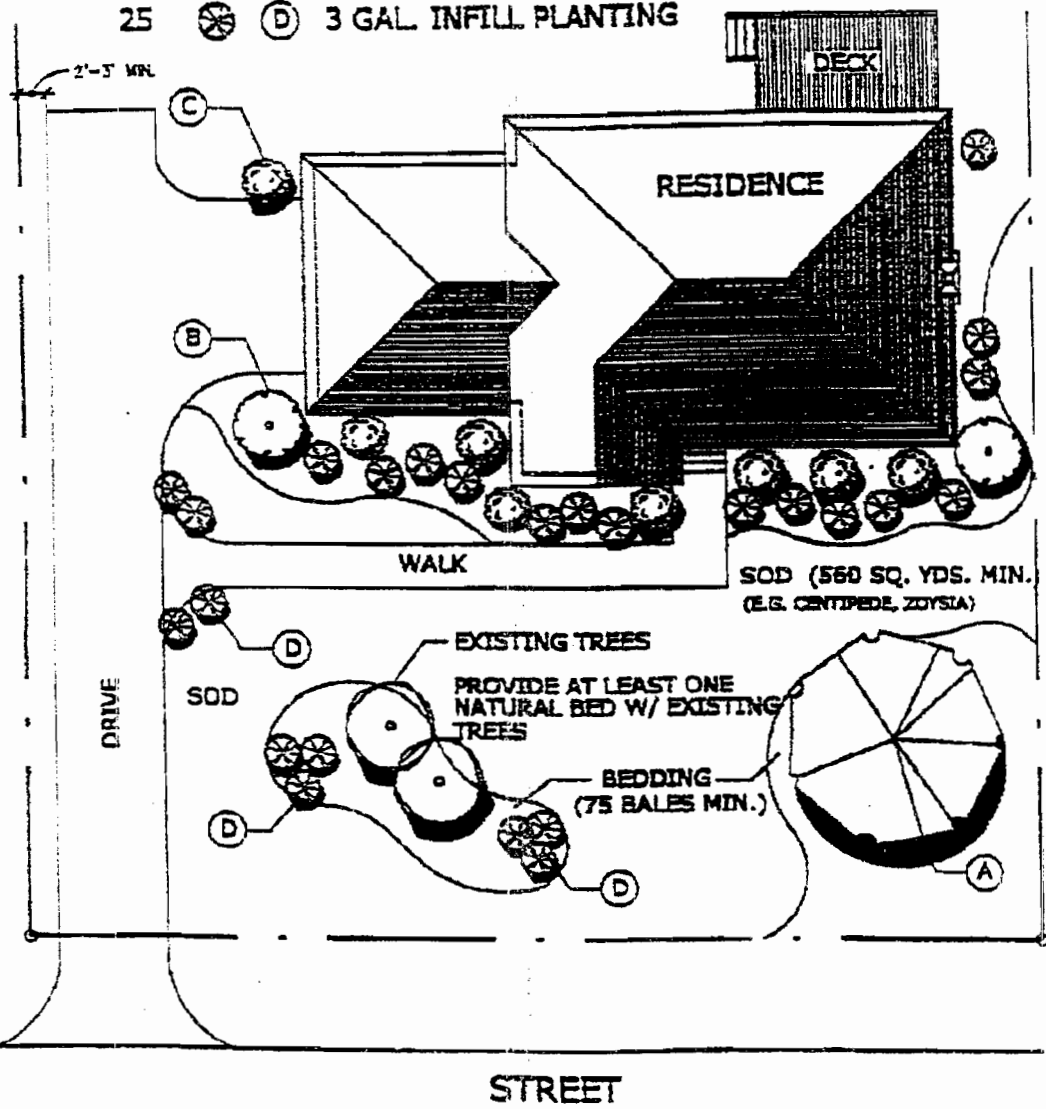

# SITE PLAN

MIN. LANDSCAPE PLAN (EXAMPLE ONLY) 1' = 10' MIN.

Plan must be submitted to ARB for approval prior to installation